



STUDIO - L'ESPADON - FONVIEILLE

3.600 €/month



DESCRIPTIVE :

Located in a charming building of Fontvieille Town, 65 sq.m studio composed of: entrance hall, main room, fitted kitchen, complete bathroom.

It enjoys 20 sq.m large loggia.

Rented with a cellar and a parking space.

REF: LM685

DETAILS



*65 m²



New



Facing north



Gardens view

CHARGES

340 €/mois

*marketable surface area

This document does not form part of any offer or contract. All measurements, areas and distances are approximate. The information and plans contained herein are believed to be correct, however, their accuracy is not guaranteed. The photographs show only certain parts of the property at the time they were taken. This offer is subject to change of price or other conditions, without prior notice.



STUDIO - L'ESPADON - FONVIEILLE





STUDIO - L'ESPADON - FONVIEILLE

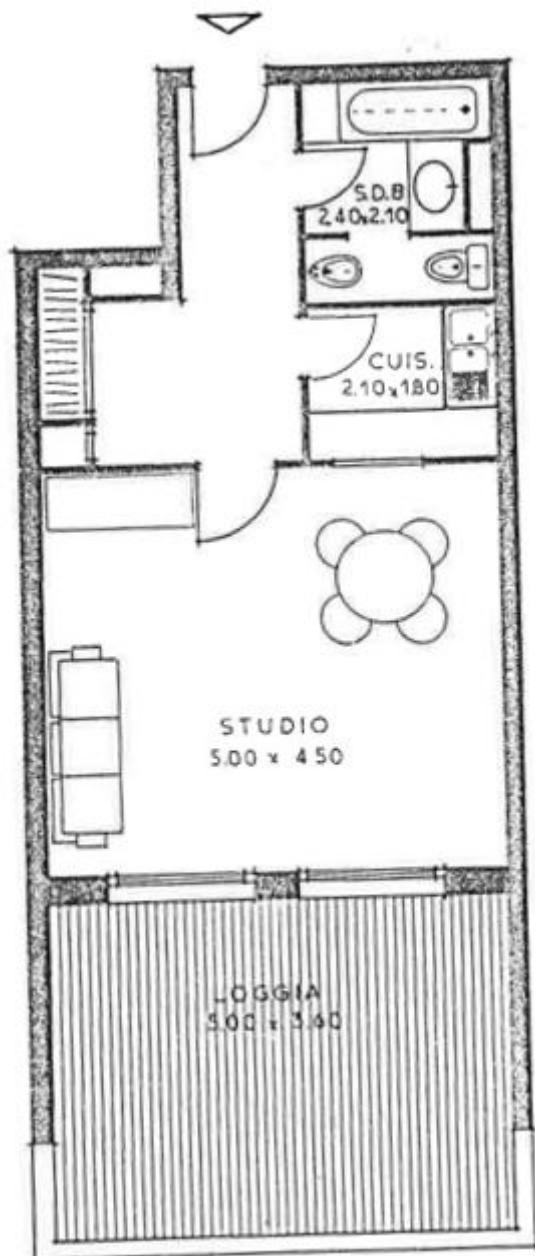



STUDIO - L'ESPADON - FONVIEILLE

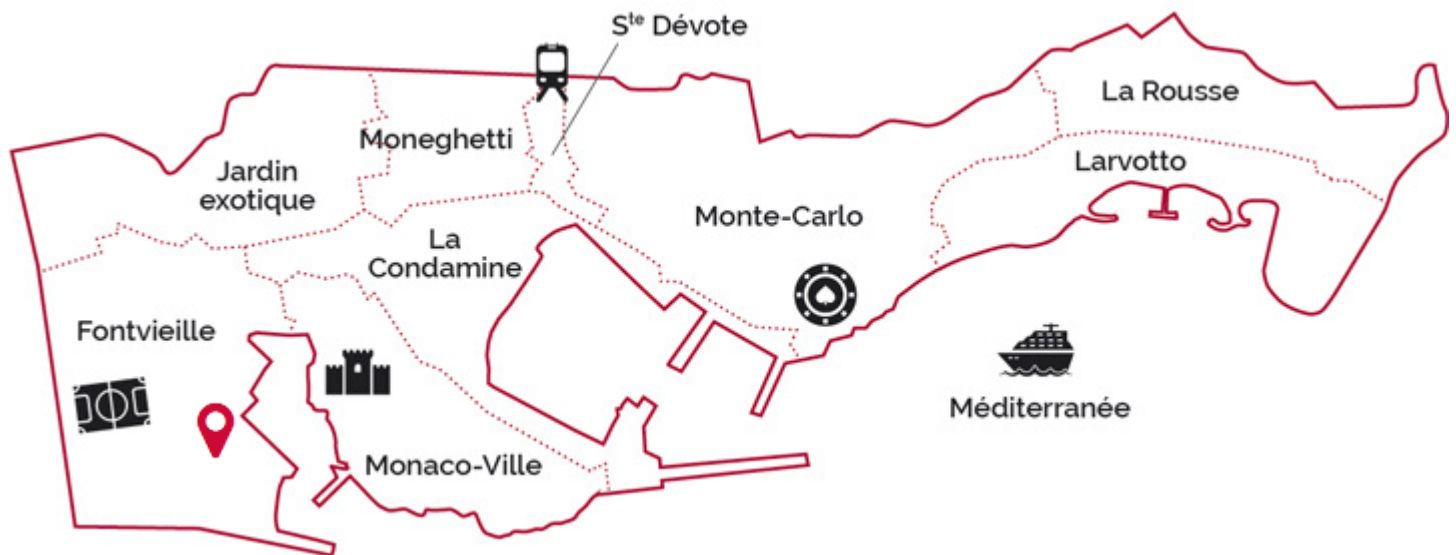

Legal This document does not form part of any offer or contract. All measurements, areas and distances are approximate. The information and plans contained herein are believed to be correct, however, their accuracy is not guaranteed. The photographs show only certain parts of the property at the time they were taken. This offer is subject to change of price or other conditions, without prior notice.