



2 ROOMS OVERLOOKING LA GRANDE BLEUE IN FONTVIEILLE

Price on request



DESCRIPTIVE :

Very beautiful 2 ROOMS with panoramic views of the Rose Garden and the sea in a prestigious building with concierge and swimming pool located in the tranquility of Fontvieille.

With a total surface area of 69 m2, it consists of: entrance hall, guest toilet, living room opening onto loggia, fitted independent kitchen, a bedroom with cupboard, a complete bathroom.

It has two loggias with a total surface area of 16 M2.

A parking completes this property.

REF: VM2207

DETAILS



*69 m²



16 m²



Good condition



1



Facing west



Sea, Rose Garden view

*marketable surface area

This document does not form part of any offer or contract. All measurements, areas and distances are approximate. The information and plans contained herein are believed to be correct, however, their accuracy is not guaranteed. The photographs show only certain parts of the property at the time they were taken. This offer is subject to change of price or other conditions, without prior notice.



2 ROOMS OVERLOOKING LA GRANDE BLEUE IN FONTVIEILLE





2 ROOMS OVERLOOKING LA GRANDE BLEUE IN FONTVIEILLE





2 ROOMS OVERLOOKING LA GRANDE BLEUE IN FONTVIEILLE





2 ROOMS OVERLOOKING LA GRANDE BLEUE IN FONTVIEILLE





2 ROOMS OVERLOOKING LA GRANDE BLEUE IN FONTVIEILLE



ROSA MARIS
FONTVIEILLE



2 ROOMS OVERLOOKING LA GRANDE BLEUE IN FONTVIEILLE





2 ROOMS OVERLOOKING LA GRANDE BLEUE IN FONTVIEILLE

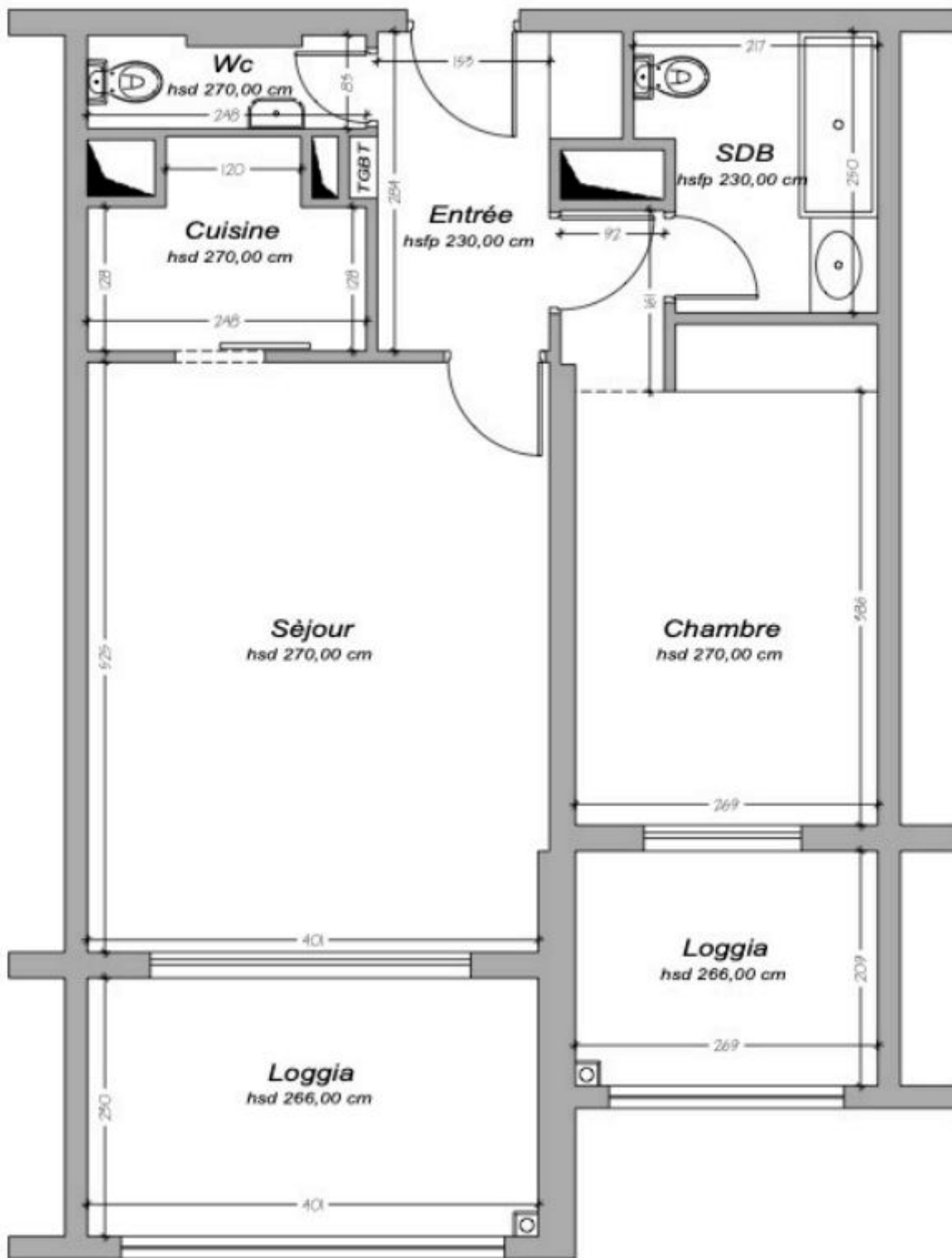



2 ROOMS OVERLOOKING LA GRANDE BLEUE IN FONTVIEILLE

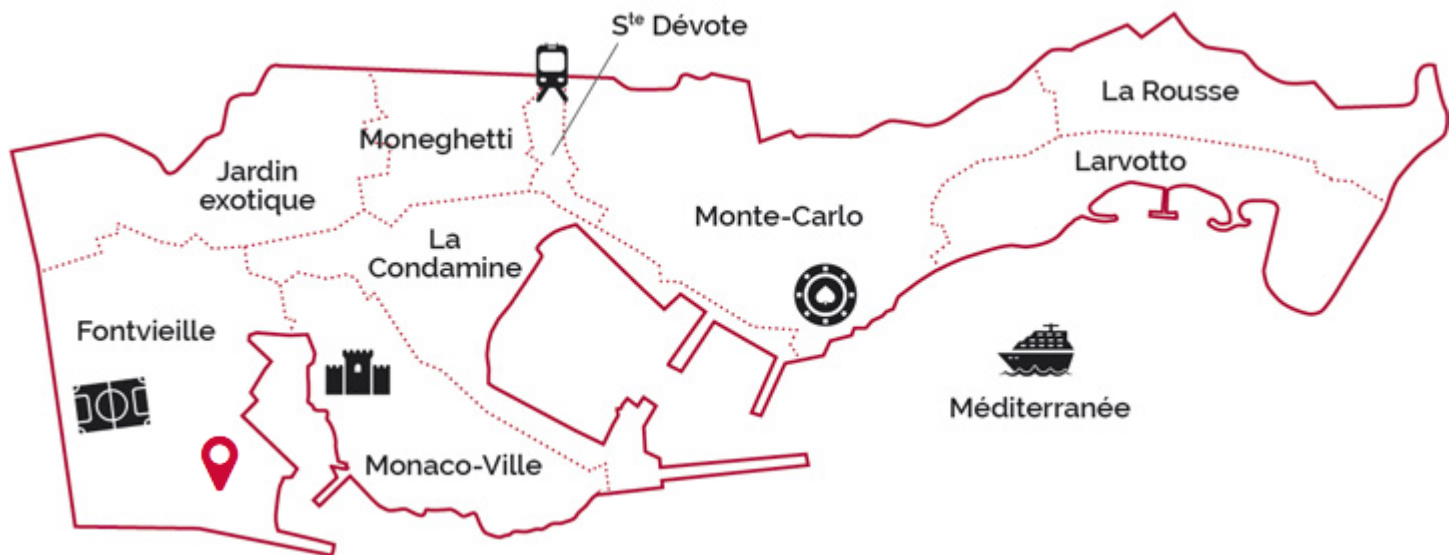

Legal This document does not form part of any offer or contract. All measurements, areas and distances are approximate. The information and plans contained herein are believed to be correct, however, their accuracy is not guaranteed. The photographs show only certain parts of the property at the time they were taken. This offer is subject to change of price or other conditions, without prior notice.